

Preprogrammed PCA Pump: Quick Setup & Programming Guide



Step A: Prepare Cassette

1. Attach Cassette to solution container.
2. Prime Cassette by squeezing solution container until all air is removed from bag and tubing.
3. Snap Cassette bottom disc into place to lock fluid path.
4. Bend away the wings of the protective cover. Insert the octagonal opening of the protective cover onto the shaft of the Cassette. Rotate shaft four (4) times counter-clockwise. Remove protective cover.



Step B: Attach Cassette to Pump

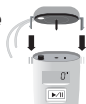

Step C: Program Pump

1. Power on the Pump (see Clinician Manual).
2. To enter the programming mode, press and hold both the Run/Pause and Bolus buttons at the same time until one (1) beep is heard. "PRO" will appear in the display.
3. Set the program number (1-5) by pressing and releasing the

Run/Pause button to increase the program number, or the Bolus button to decrease the program number.

4. To accept the program number, press and hold either the Run/Pause or Bolus button until one (1) beep is heard.
5. If Program 1-4 is chosen, set the Volume to be Infused by pressing and releasing the Run/Pause button to increase the volume, or the Bolus button to decrease the volume.
6. Once the desired Volume to be Infused is blinking on screen, press and hold either the Run/Pause or Bolus button until one (1) beep is heard.
7. If Program 5 is chosen, move on to step C: number 8.
8. The "ml/hr" indicator will begin to blink. Set the infusion rate by pressing and releasing the Run/Pause button to increase the rate, or the Bolus button to decrease the rate.
9. To accept the setting, press and hold either button. The pump will beep and advance to the tenths number.
10. Repeat steps 8 and 9 to set the Bolus Volume, Bolus Lockout Time, and the Volume to be Infused. When all steps are complete, the Pause indicator will blink in the display.

Program #5 Example Settings

Infusion Rate	3.0
Bolus Volume	2.2
Bolus Lockout Time	00:20
Volume to be Infused	250
Pause Indicator	

Step D: Start Infusion

1. Press and hold the Run/Pause button until one (1) beep is heard. **NOTE: If button is not held until beep is heard, pump will not go into run mode.**
2. The green Run light (inside the Bolus button) will begin to blink.

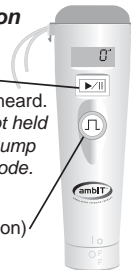

Step E: Pausing Infusion

1. Press and hold the Run/Pause button until two (2) beeps are heard. The Pause indicator will be displayed. **NOTE: If button is not held until beeps are heard, pump will not go into pause mode.**

Step F: Review Program Settings

1. Place the Pump in pause mode.
2. Press and release the Bolus button. Rx will appear in the display. Pump will then scroll through the program settings: (Program #, Basal Rate, Bolus Volume, Bolus Lockout Time, and Volume to be Infused).

Step G: Viewing & Clearing History

1. Viewing History:

- a. Place the Pump in Pause.
- b. Press and hold the Bolus button until one (1) beep is heard and "HX" is in the display.

Release button and the Pump will scroll through the four history parameters:

1. total ml infused
2. # of bolus delivered
3. # of bolus requests
4. elapsed time

2. Clearing History:

(Pump must be unlocked. See Clinician Manual.)

- c. Perform steps a and b.
- d. Release the button and again press and hold the Bolus button until one (1) beep is heard and "HX 0" is displayed.
- e. Press and hold the Run/Pause button again until one (1) beep is heard to resume infusion.

For 24 hour Clinical / Technical Assistance:

Call: (801) 352-1888

Toll Free (U.S.): (877) 352-1888

For complete pump operation instructions, see Clinician Manual.

1375 West 8040 South, West Jordan, UT 84088, USA

Fax: (801) 352-1818 www.sorensonmedical.com



SORENSEN MEDICAL

62410.03 3/07

Preprogrammed PCA Pump: Quick Setup & Programming Guide



SUMMARY OF CONTROLS

To	Step to Take	Audible Indicator	Visual Indicator
Start Infusion	After Pump is properly programmed, press and hold Run/Pause button	▶/	Green Light blinks (inside Bolus button) and volume infused (ml) is indicated in display
Pause Infusion	Press and hold Run/Pause Button	▶/	Pause Icon flashing in display
Silence Alarm	Press and release Run/Pause button	▶/	Pause Icon flashing in display
Deliver Bolus	Press and release Bolus button	Ⓢ	Green Light double blinks

NORMAL CONDITIONS

Visual	Audible	Indication
Green Light single blink	None	Infusing normally
Green Light double blink	1 beep upon bolus initiation	Infusing bolus
Pause Icon flashing	2 beeps every 4 minutes	Infusion has been paused
Bag Icon	1 long tone followed by 3 short beeps, repeats every 4 minutes	Infusion complete. The Pump will deliver a KVO rate (0.5 ml/hr). If the basal infusion rate is less than 0.5 ml/hr, the Pump will continue at the set basal rate. This will continue until Pump is placed in pause mode.

TROUBLESHOOTING TABLE

Visual	Audible	Indication
Blank Display	None	Pump off, dead batteries, or improper battery placement
Alarm Icon and "OCL" in display	Constant beeping	Fluid path occlusion: check for downstream occlusion or clamped tubing
Cassette will not prime	None	Make sure Cassette bottom disc has not been snapped into Cassette body
Low Battery	5 short beeps every 4 minutes	Batteries are low and should be replaced at earliest convenience
Battery Icon & Alarm Icon displayed	Constant tone	Batteries are dead and must be replaced immediately
Alarm Icon and "MA" in display	Constant tone	Press and release Run/Pause button to silence alarm. Press and release Run/Pause button to re-start Pump. Check Cassette for proper attachment to Pump. Pump malfunction - clamp tubing and refer to operator's manual.

For 24 hour Clinical / Technical Assistance Call: (801) 352-1888
Toll Free (U.S.): (877) 352-1888

For complete pump operation instructions, see Clinician Manual.

1375 West 8040 South, West Jordan, UT 84088, USA
Fax: (801) 352-1818 www.sorensonmedical.com



SORENSEN MEDICAL

62410.03 3/07